

GREASE CARTRIDGE ADAPTER

“NEW” Grease cartridge adapters are designed to take advantage of readily available grease cartridges. These cartridges are available in most commonly used NLGI grades at the retail or wholesale level. These brass adapters are ideally suited for operation with **LUBE DEVICES, INC.** Precision metering pumps **PMP100** (air operated Bulletin F1837-1) and **PMP200** (motor operated Bulletin F1837-2).

STANDARD MATERIALS:

- Brass construction
- Buna N Seals

OPERATING CONDITIONS:

- Maximum working temperature up to 120°F (48.9°C)

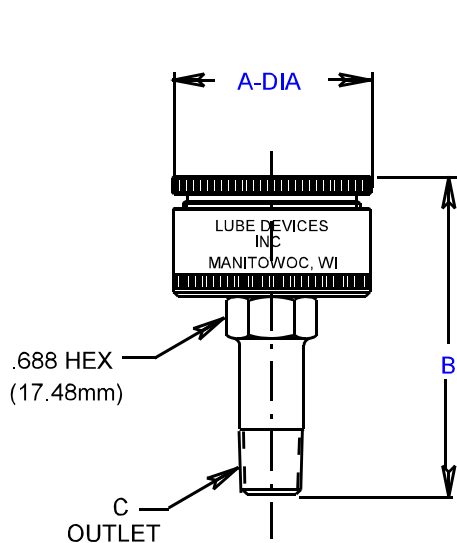

Insert the “follower disc” until it touches grease (do not force). The “follower disc” is required to exclude dirt and prevent air holes in the grease.

Leave the disc “line” extended and free as shown and it will give a visual indication of how much grease is remaining as the “follower disc” moves down the cartridge. The “line” is also used to retrieve the “follower disc” for reuse when the cartridge is empty.

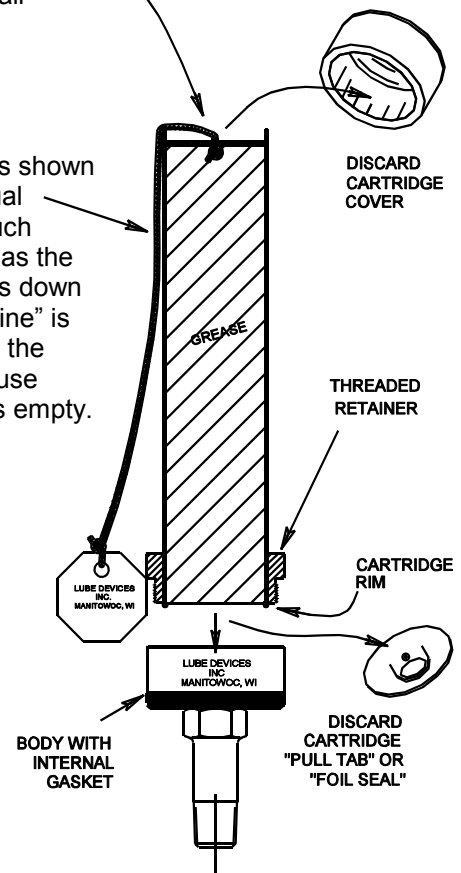

GCA100 Adapts the nominal 3 ounce (85g) standard cartridge size 1.31 (33.27mm) dia x 6.00 (152.40mm) long

GCA200 Adapts the nominal 14 ounce (397g) standard cartridge size 2.12 (53.85mm) dia x 9.00 (228.60mm) long

- Patent Number 6,149,037

CATALOG NUMBER	A INCHES (mm)	B INCHES (mm)	C OUTLET	CAPACITY-NOMINAL CARTRIDGE WEIGHT
GCA100	1.75 (44.45)	2.75 (69.85)	1/4-18NPTF	3 ounce (85g)
GCA200	2.50 (63.50)	2.81 (71.37)	1/4-18NPTF	14 ounce (397g)



LUBE DEVICES, INC.

1864 NAGLE AVE., P.O. BOX 1810, MANITOWOC, WI 54221-1810
 PHONE: (920) 682-6877 FAX: (920) 684-7210
 E-MAIL: sales@lubedevices.com WEBSITE: www.lubedevices.com

GREASE CARTRIDGE ADAPTER

12/02 **BULLETIN F1867-1**